

VDI SAFETY

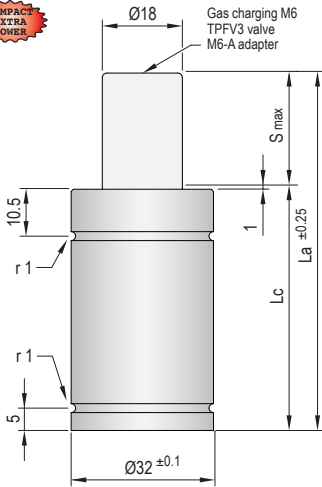

PED
2014/68/EU

COMPACT
EXTRA
POWER



- Pressure medium **Nitrogen (N₂)**
- Max. charging pressure **190 Bar**
- Min. charging pressure **25 Bar**
- Rod seal area **2,54 cm²**
- Operating temperature **0°C - 80°C**
- Force increase by temperature **0,33 %/°C**
- Max. stem speed **1,2 m/s**
- Maintenance kit **Kit T32**



Maximum strokes / minute (at 20°C)

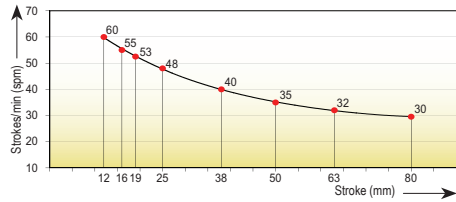

Code	Smax mm	La mm	Lc mm	Fa daN	85% F daN	100% Fc daN	P Bar	V l	Kg
TITAN 32x12	12	49	37	500 ±5% (20°C)	735	800	190 (20°C)	0,008	0,19
TITAN 32x16	16	58	42		740	805		0,011	0,21
TITAN 32x19	19	65	46		740	810		0,013	0,22
TITAN 32x25	25	76	51		745	815		0,017	0,24
TITAN 32x38	38	102	64		750	820		0,025	0,27
TITAN 32x50	50	127	77		750	820		0,033	0,30
TITAN 32x63	63	152	89		750	825		0,041	0,34
TITAN 32x80	80	186	106		750	825		0,052	0,41

Force/stroke ratio

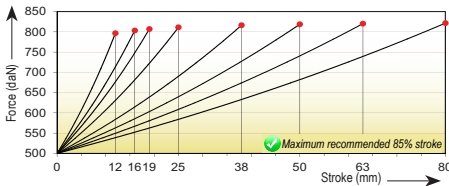

Initial force/charging pressure ratio

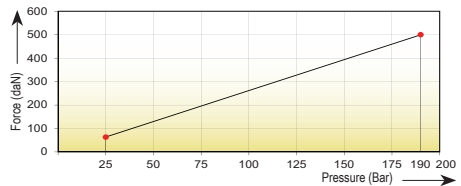

Assembly possibilities



Follow guidelines
Page 287



DROP-IN

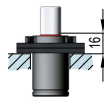

FS 32
FS 32/1-FSC 32



FS 32
FS 32/1-FSC 32

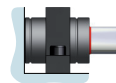

FI 32-FI 32/1